

# Harp Renewables CX20 Aerobic Digester

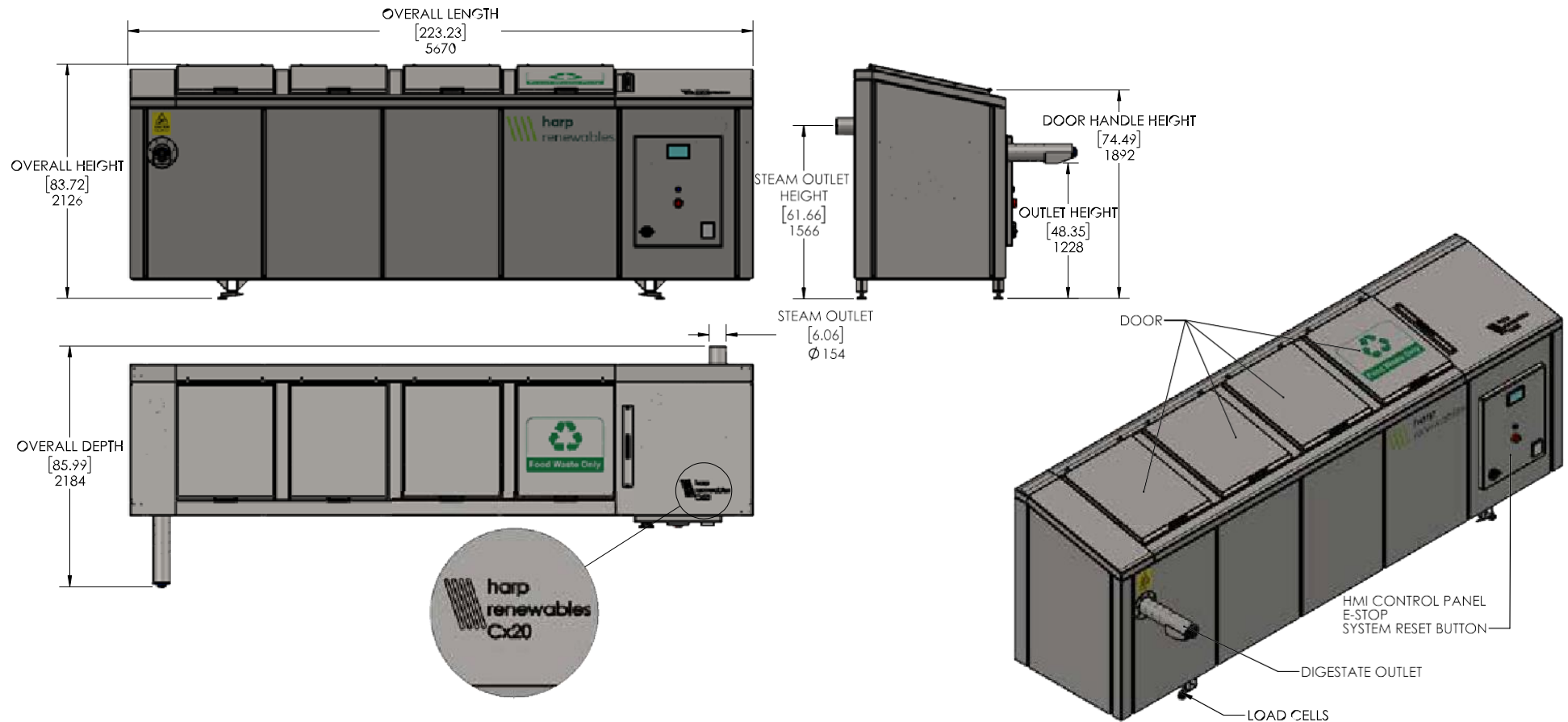

<b>Type:</b>	Accelerated Aerobic Bio-digester
<b>Operation:</b>	Continuous
<b>Process:</b>	Thermophilic (70°C Nominal)
<b>Insulation:</b>	Fully Insulated Shell
<b>Dimensions:</b>	Length: 5670mm (223.23")
	Depth: 2184mm (85.99")
	Height: 2126mm (83.72")
	Height With Door Opened: 3290mm (129.53")

<b>Max Input Capacity:</b>	20,000 Litres /week
<b>Nominal Output Rate:</b>	Approx. 15-30% of input rate
<b>Volume Reduction</b>	85-70% (Approx.)
<b>Motor Power Ratings:</b>	5.5kW / 0.37kW / 0.75kW
<b>Heater Thermal Power:</b>	22kW (total)
<b>Options:</b>	Remote Monitoring & Control (optional), Automated infeed system (Infeed hopper and or shredder), Bin Lifter, Standalone Shredder, Integrated Ozone Unit, Load cells

<b>Electrical Usage (Kwh/year):</b>	35254.13
<b>EU Option Required Power Supply:</b>	3 Phase / 400V / 63A
<b>USA option Required Power Supply:</b>	3 Phase / 480V / 63A

Optional extras may increase the required current. Specifications are subject to change without notice.